

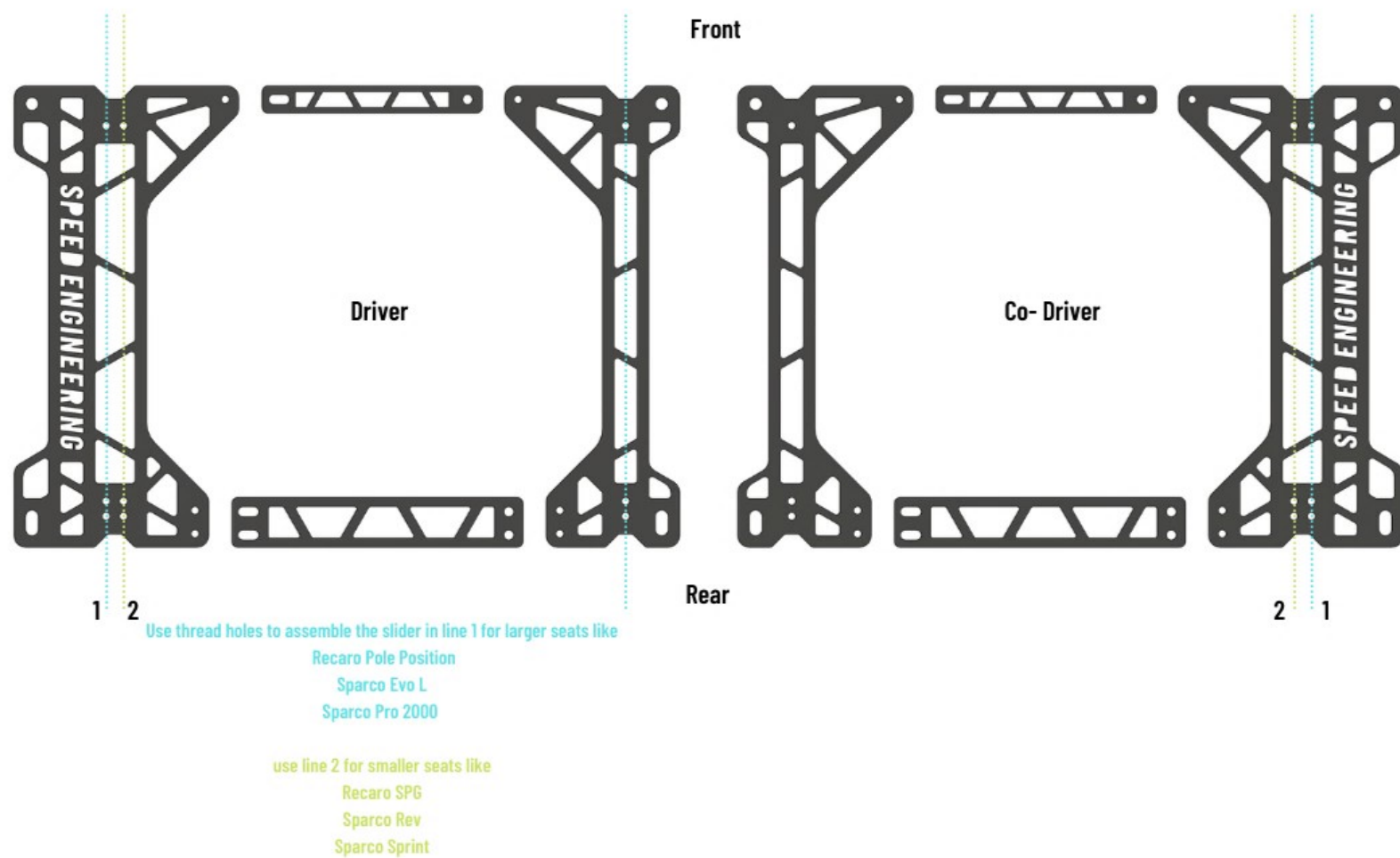

BMW E36 / E46 Seat Mount Kit Manual



This product is designed and produced by the SPEED Engineering GmbH.
If you have any questions or comments,
please feel free to contact us.

STEP 1

Console assembly
Driver

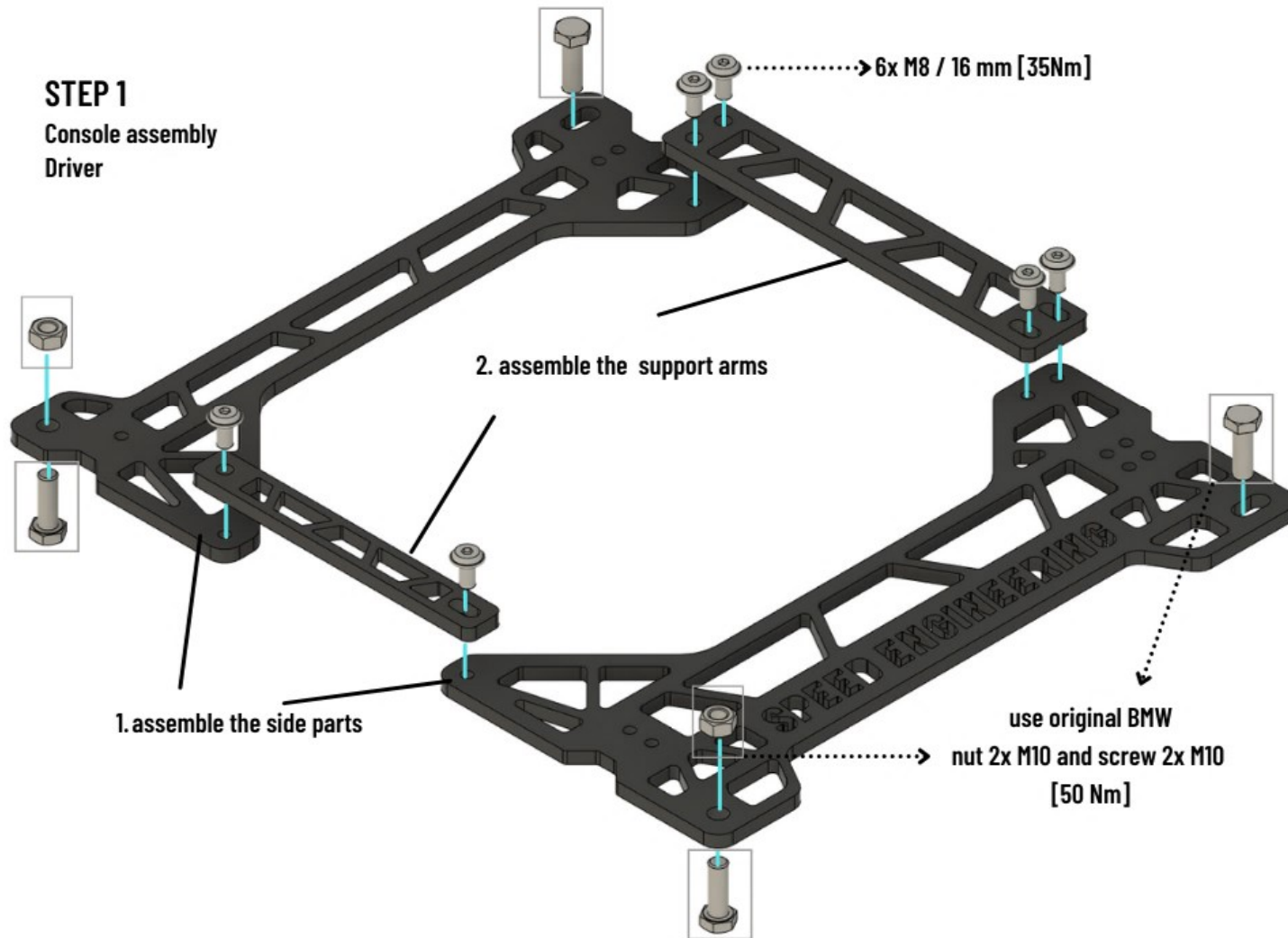

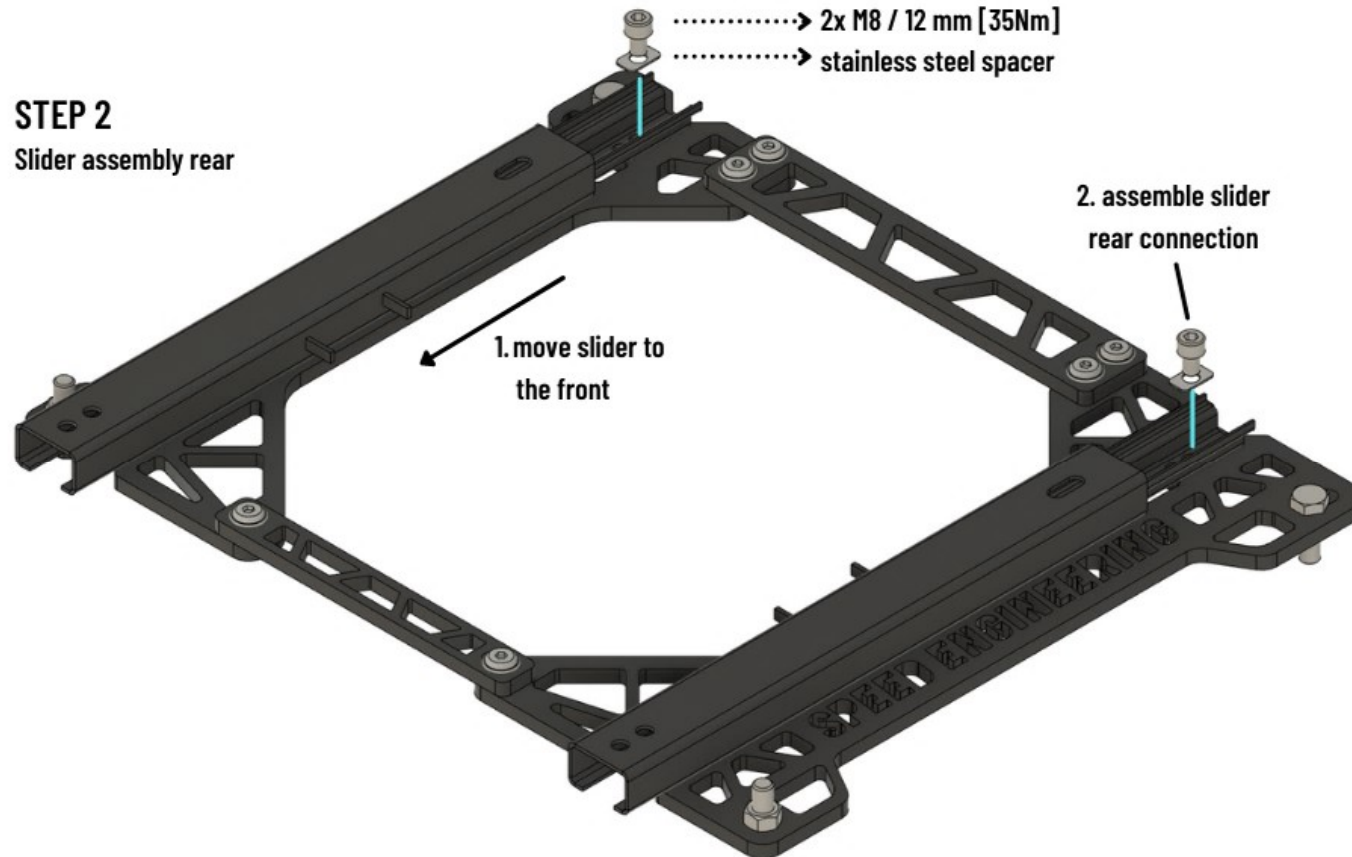

STEP 3

Slider assembly front

2x M8 / 12 mm [35Nm]

stainless steel
spacer

1. move slider to
the rear

2. assemble slider
front connection

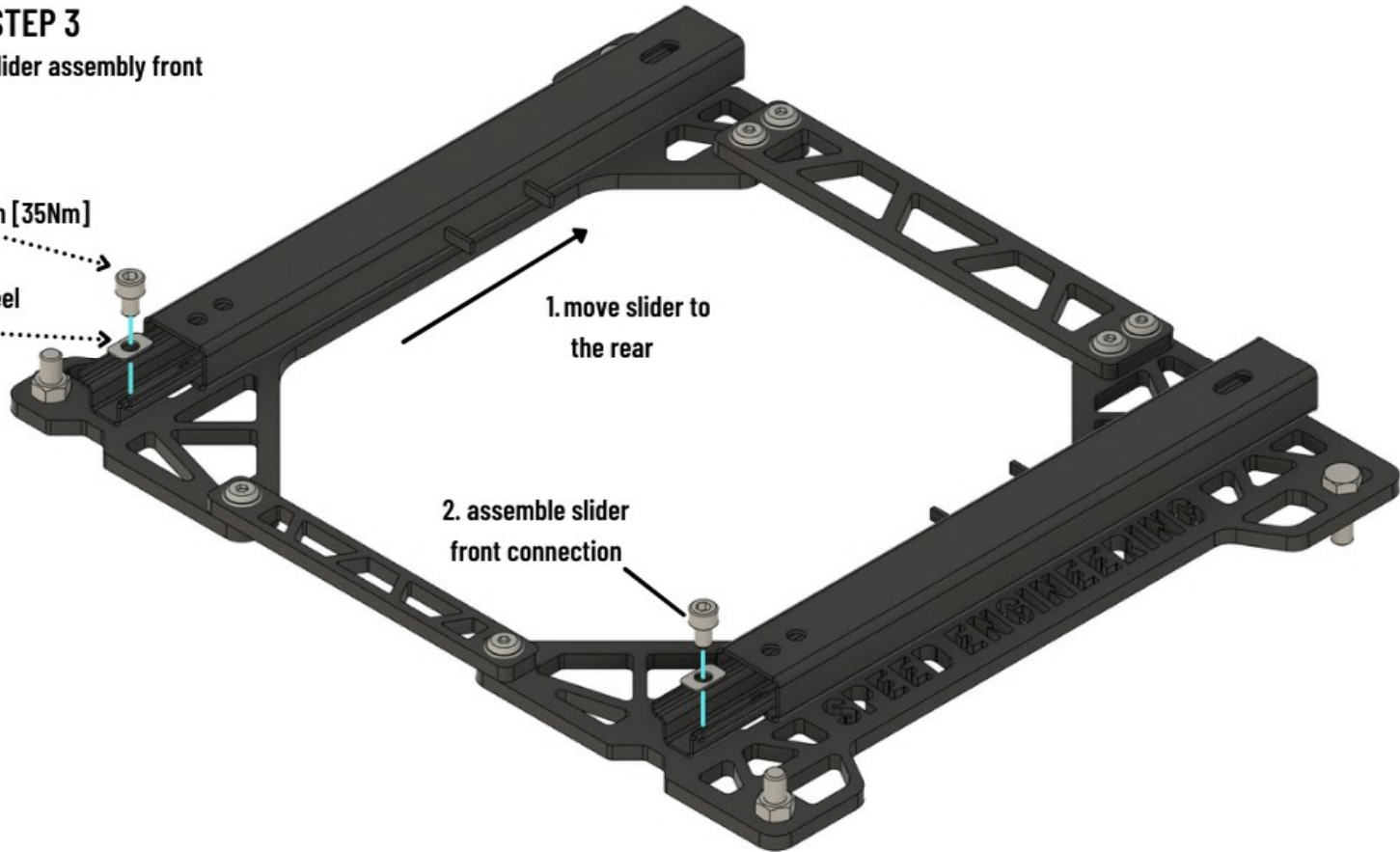

STEP 4
Slider lever assembly

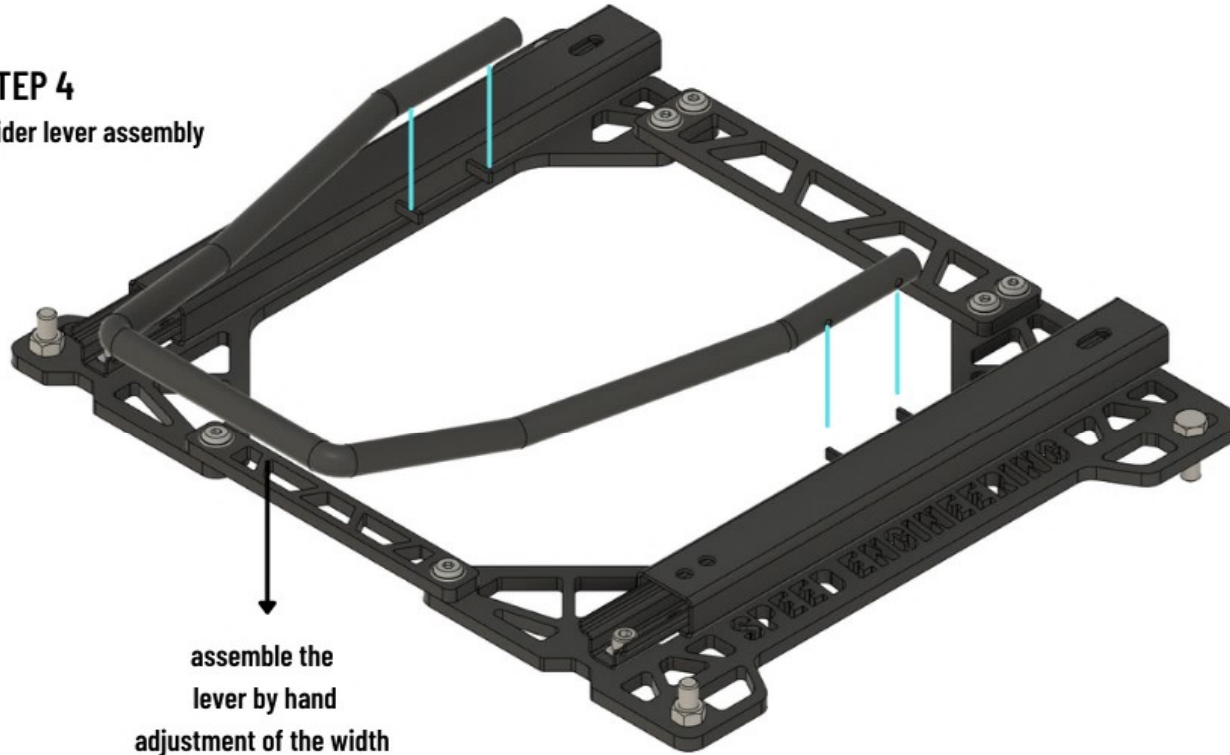

assemble the
lever by hand
adjustment of the width
by pulling the lever ends by hand

STEP 5

L Adaptor assembly front

2x M8 nut [30 Nm] ←
4x M8 spacer ←

2x M8 / 16 mm [30 Nm] ←

If the seat position is not known yet,
only hand tight assembly is recommended.
Final assembly can be done with the installed seat.

recommendation:
use special slider tool to counter the
screw inside the slider, Art. 13202

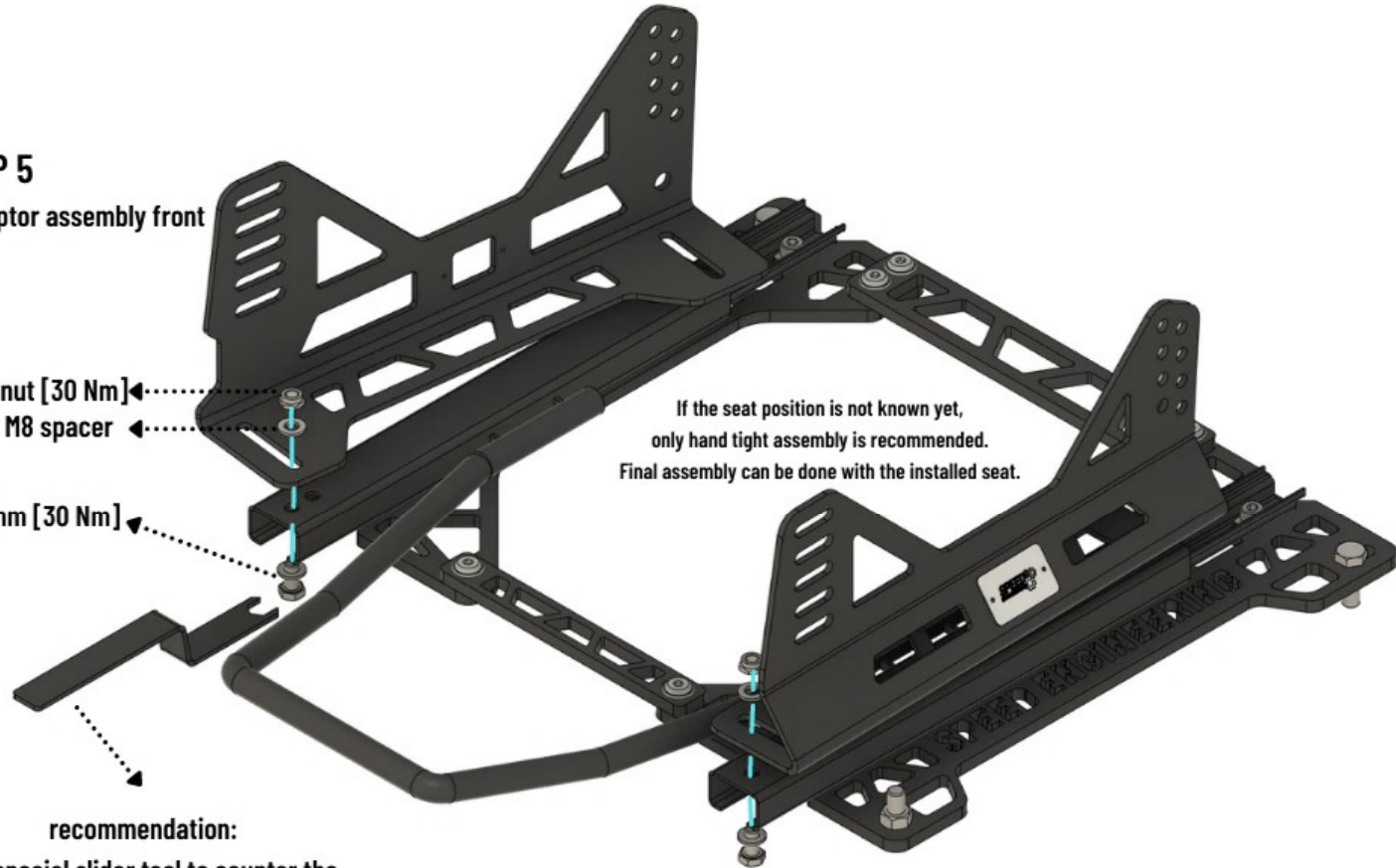

STEP 6

L Adaptor assembly rear

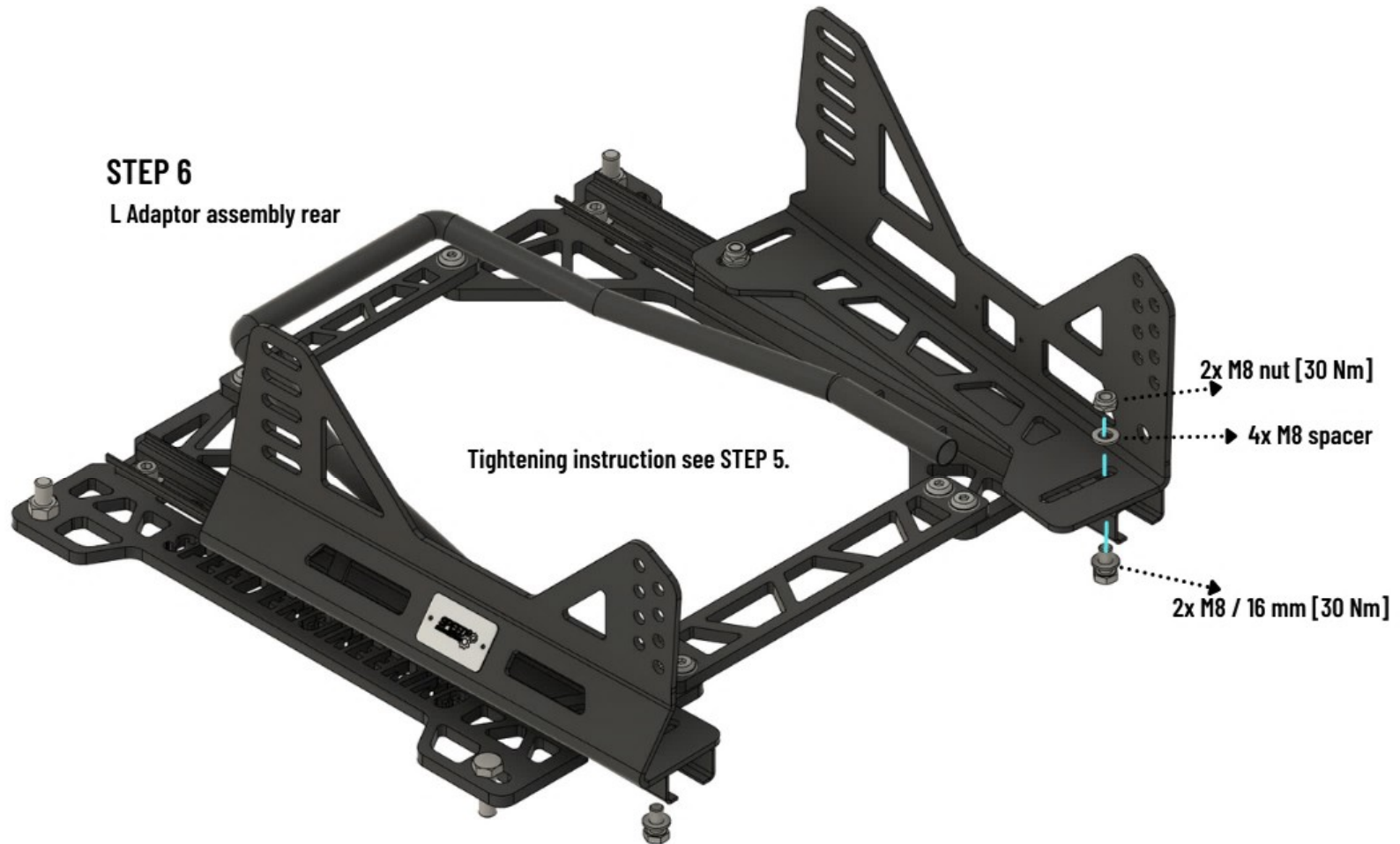

STEP 7
Seat assembly

4x M8 / 30 mm [30 Nm]
4x M8 spacer

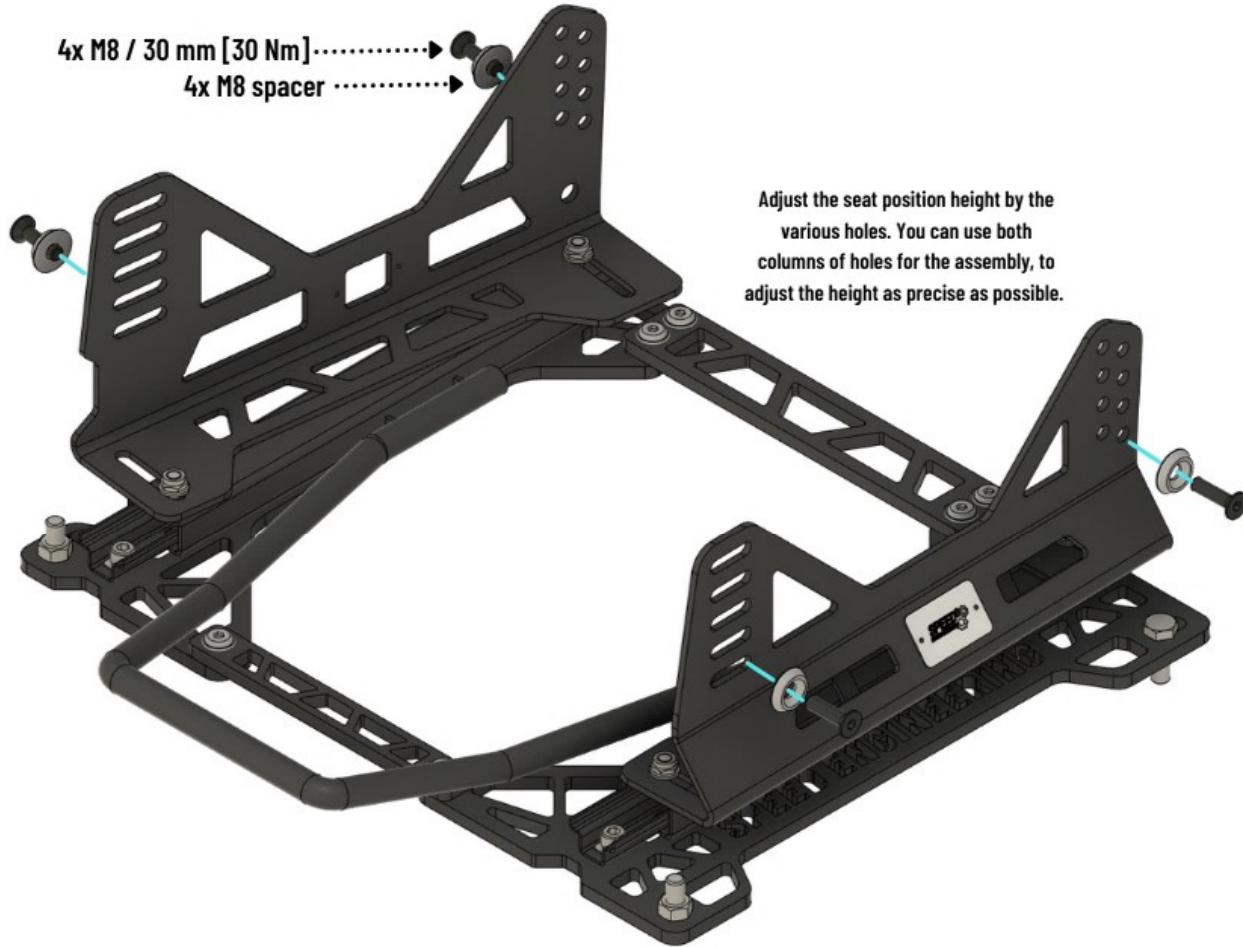

Adjust the seat position height by the various holes. You can use both columns of holes for the assembly, to adjust the height as precise as possible.

STEP 8
Seat adjustment
Driver



Enjoy the ride.